

1

SINGLE ARM PICTURE LIGHT
(100 - 700mm)

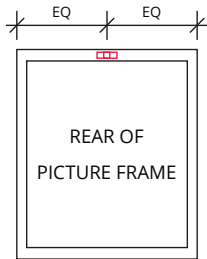

MEASURE FRAME AND
MARK OUT BRACKET
LOCATIONS FOR
APPROPRIATE PICTURE
LIGHT.

DOUBLE ARM PICTURE LIGHT
(850mm - 1150mm)

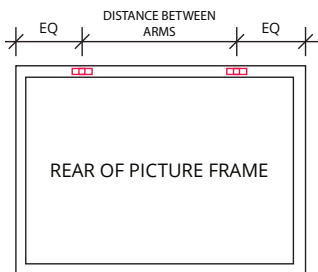

TRIPLE ARM PICTURE LIGHT
(1300mm - 1450mm)

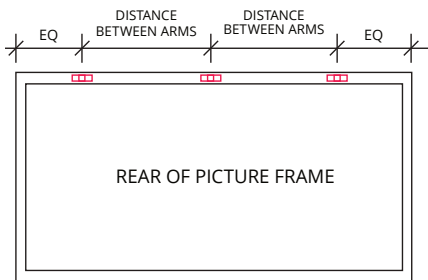

IF MORE THAN ONE PICTURE LIGHT PER ARTWORK.
ALLOW 50-100mm BETWEEN PICTURE LIGHT
HOUSINGS.

2

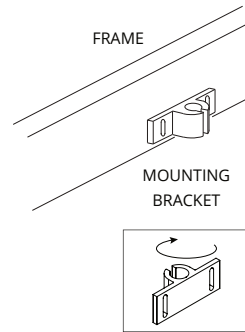

CHECK THICKNESS OF FRAME AND SELECT 4x
SCREWS OF APPROPRIATE LENGTH AND SIZE

DO NOT MOUNT TO STRETCHER OR MOUNT
BOARD.

ENSURE FIXING IS SECURE.

IF BRACKET CAN NOT BE MOUNTED TO FRAME,
THE BRACKET CAN BE ROTATED 180 °
TO ALLOW FIXING TO THE WALL BEHIND THE
ARTWORK.

3

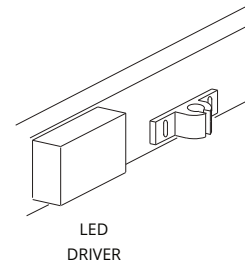

CHECK DIMMING PROTOCOL SYSTEM ON SITE:

- FOR 1-10V & DALI ALLOW CABLE IN ADDITION
TO MAINS POWER CONTROL CABLE.
- FOR MAINS/PHASE ENSURE MINIMUM LOAD
DIMMING SYSTEM IS COMPATIBLE WITH
LED DRIVER.
- ENSURE PICTURE LIGHTS ARE ON A SEPARATE
CIRCUIT FROM OTHER LIGHTING WITHIN
THE ROOM FOR BEST DIMMING RESULTS.
- FOR LOCAL DIMMING AT ARTWORK. PICTURE
LIGHTS SHOULD BE ON A SWITCHED (NOT
DIMMED) CIRCUIT.

4

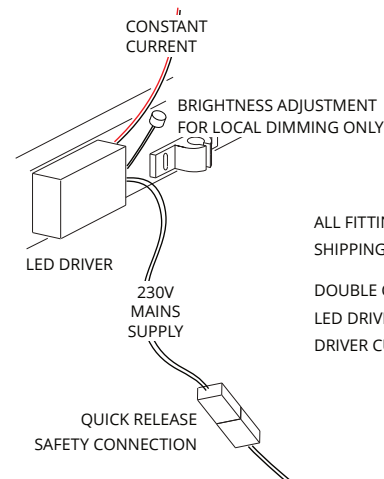

ALL FITTINGS SHOULD BE PRE-SET PRIOR TO
SHIPPING TO THE CORRECT DRIVE CURRENT.

DOUBLE CHECK DIP SWITCH SETTINGS ON
LED DRIVER AND RESET TO THE APPROPRIATE
DRIVER CURRENT IF REQUIRED.



IMPORTANT PLEASE READ BEFORE INSTALLATION

- WARNING: **DO NOT** connect fixtures directly to mains Voltage (220V-240V) AC. This will PERMANENTLY damage the product and void warranty.
- Installation should be carried out in accordance with the latest relevant wiring regulations for the applicable country or territory.
- Installation should be carried out by a qualified electrician.
- Ensure all electrical connections are tight with no loose strands, including factory made connections.
- Use only with the approved driver for this product and check the required CONSTANT CURRENT or CONSTANT VOLTAGE wiring guidelines.
- Luminaire and fixing are for indoor use only.
- LED driver must **NOT** be covered with insulation material; this will reduce lifespan, invalidate warranty and cause risk of fire.

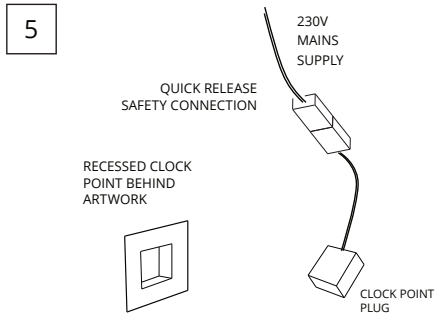

IF USING CLOCK POINTS BEHIND ARTWORK, REMOVE CLOCK POINT PLUG AND WIRE AS PER ELECTRICAL STANDARDS.

DO NOT INSERT PLUG AT THIS POINT.

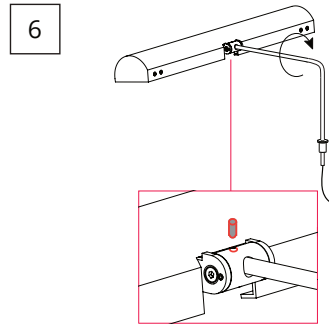

REMOVE PICTURE LIGHT FROM PACKAGING.

LOOSEN LOCKING NUT USING 1.5mm ALLEN KEY IN TOP OF BRACKET AND ROTATE THE ARM.

ONCE IN PLACE, TIGHTEN LOCKING NUT.

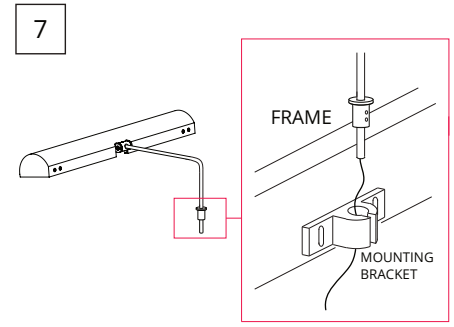

INSERT PICTURE LIGHT BUSH INTO MOUNTING BRACKET.

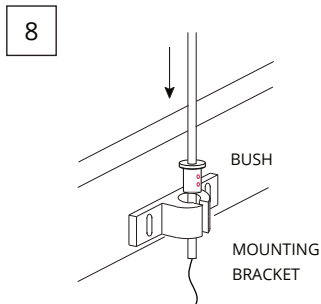

LOOSEN 2NO. x M3 LOCKING SCREWS ON PICTURE LIGHT BRACKET BUSH.

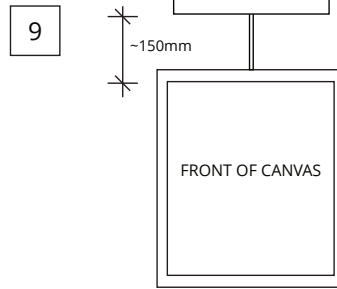

SET HEIGHT OF PICTURE LIGHT TO APPROXIMATELY 150mm ABOVE TOP OF CANVAS.

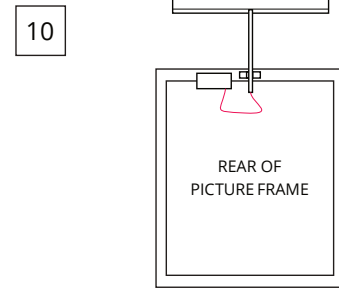

CONNECT LOW VOLTAGE PICTURE LIGHT CABLES INTO LED DRIVER. INSERT REMOTE DIMMING CABLES TO DRIVER WHERE APPLICABLE. IF ON A SWITCHED CIRCUIT, USE LOCAL POTENTIOMETER.

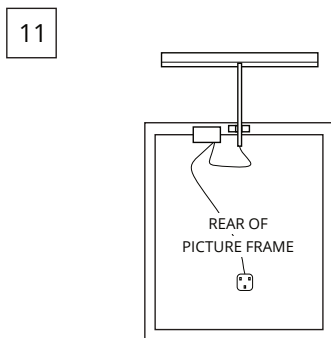

DOUBLE CHECK ALL ELECTRICAL CONNECTIONS.

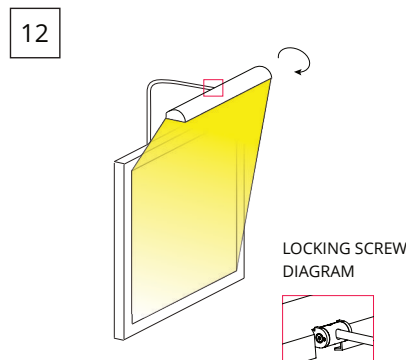

INSERT PLUG INTO WALL RECESSED CLOCK POINT BEHIND ARTWORK LOCATION. MOUNT ARTWORK. TURN ON PICTURE LIGHT POWER AT SWITCH. ROTATE PICTURE LIGHT HEAD TO ACHIEVE DESIRED LIGHT DISTRIBUTION ON ARTWORK. LOCK HEAD POSITION USING ALLEN KEYS PROVIDED.

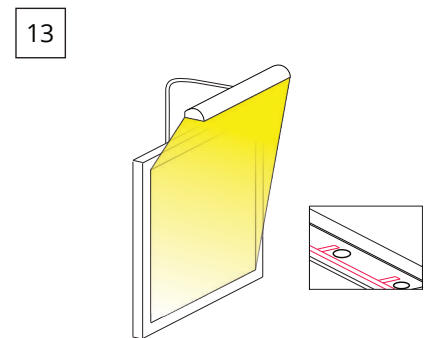

LOOSEN LOUVRE USING ALLEN KEYS PROVIDED. ADJUST GLARE LOUVRE TO AVOID GLARE WHEN LOOKING UP AT THE PICTURE LIGHT. DIM LIGHT LEVEL TO ACHIEVE DESIRED LIGHT LEVEL ON PAINTING USING REMOTE POTENTIOMETER OR DIMMING CONTROL SYSTEM.