



**PRODUCT DESCRIPTION**

|                     |                                 |
|---------------------|---------------------------------|
| <b>DESCRIPTION</b>  | LED DOWNLIGHT ENGINE            |
| <b>CATEGORY</b>     | IP20 - FOR INDOOR USE ONLY      |
| <b>MATERIAL</b>     | MACHINED ALUMINIUM              |
| <b>FINISH</b>       | BLACK ANODISED                  |
| <b>DIMMING</b>      | 1-10V   DALI   PHASE   SWITCHED |
| <b>POWER SUPPLY</b> | REMOTE DRIVER                   |
| <b>ACCESSORIES</b>  | SEE BELOW                       |
| <b>WEIGHT</b>       | 0.2kg                           |

**LIGHT ENGINE**

|                          |  |
|--------------------------|--|
| <b>POWER</b>             | 12.8W  |
| <b>CURRENT</b>           | 700mA CONSTANT CURRENT                             |
| <b>LAMP LUMENS</b>       | 2700K   1030lm<br>3000K   1110lm<br>4000K   1205lm |
| <b>COLOUR RENDERING</b>  | CRI 98 Typ.  |
| <b>BEAM DISTRIBUTION</b> | FWHM 10°   + Accessories                           |
| <b>LAMP LIFE</b>         | >105,000 hours - LM70                              |



**DIMENSIONS**

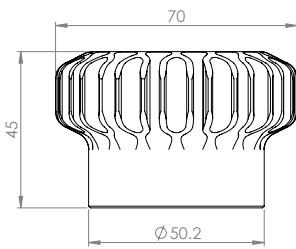

**ACCESSORIES**

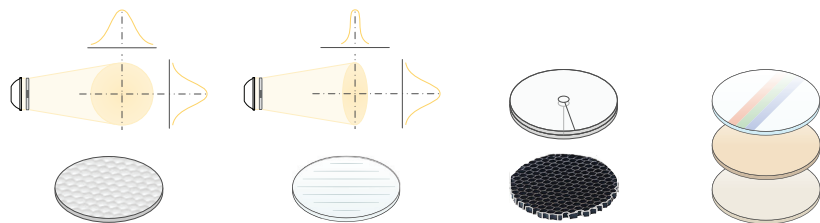

|   |  |  |   |
|---|--|--|---|
| <p><b>BEAM WIDTH LENSES</b></p> <p>5031-0106 - 17° NARROW<br/>5031-0037 - 25° NARROW FLOOD<br/>5031-0038 - 36° FLOOD<br/>5031-0039 - 60° WIDE FLOOD</p> | <p><b>BEAM SHAPING LENSES</b></p> <p>5031-0096 - 10X25° LINEAR<br/>5031-0108 - 10X36° LINEAR<br/>5031-0110 - 10X60° LINEAR<br/>5031-0115 - 36X36° SQUARE</p> | <p><b>BEAM CONTROL LENSES</b></p> <p>5031-0116 - AIMABLE (PAIR)<br/>5031-0002 - H/C LOUVRE</p> | <p><b>COLOUR LENSES</b></p> <p>5031-0053 - ¼ CTO<br/>5031-0054 - ½ CTO<br/>5031-0157 - CLEAR*</p> |
|---|--|--|---|

\* To be used with colour gels.

**PRODUCT CODE** E1100A.XX.XX

| LUMINAIRE TYPE            | COLOUR TEMP                         | DISTRIBUTION   | DIMMING                      | ACCESSORIES**  |
|---------------------------|-------------------------------------|----------------|------------------------------|--|
| <b>E1100A. LED MODULE</b> | 27. 2700K<br>30. 3000K<br>40. 4000K | 10. 10° (std.) | + 1-10V<br>+ DALI<br>+ PHASE | + BEAM WIDTH LENSES<br>+ BEAM SHAPING LENSES<br>+ BEAM CONTROL LENSES<br>+ COLOUR LENSES |

\*\*Up to 3 accessories can be attached.